



ARCHITECTURAL & ENGINEERING SPECIFICATION

Prefabricated stainless steel 3 person shower unit with integral mounting frame, unit consists of three TEMP-GARD pressure balancing shower valves with single bronze stem, stainless steel balancing piston & bottom access integral service stops. Standard with 3/4" [19mm] copper tubing assembly enclosed by 18 gage stainless steel #4 brushed finish shroud, chrome plated brass shower head with flow control on institutional bracket, metal stem handle & all vandal proof securing screws. Unit is hydrostatically tested & ready for installation.

PRODUCT FEATURES

- Three pressure balancing shower valve with single bronze stem
- Chrome-plated brass shower heads with flow control
- 18 Gage Stainless Steel shroud

COMPLIANCE AND CERTIFICATION:

- Shower head, valve and plumbing fittings- Complies with ASME A112.18.1 / CSA B125.1
- Valve - Complies with ASSE 1016-2005



SUFFIX OPTIONS

- | | |
|-------|---|
| -i2 | Fixed Spray Institutional Shower Head (2.5 GPM) |
| -i5 | Large Brass Shower Head with Adjustable Spray Pattern (2.5 GPM) |
| -i9 | Fixed Spray Institutional Shower Head (1.5 GPM) |
| -1.25 | 1.25 GPM Shower Head Flow Control |
| -1.5 | 1.5 GPM Shower Head Flow Control |
| -1.75 | 1.75 GPM Shower Head Flow Control |
| -2.0 | 2.0 GPM Shower Head Flow Control |

ARCHITECTURAL & ENGINEERING APPROVAL

Rough-in/Overview dimensions

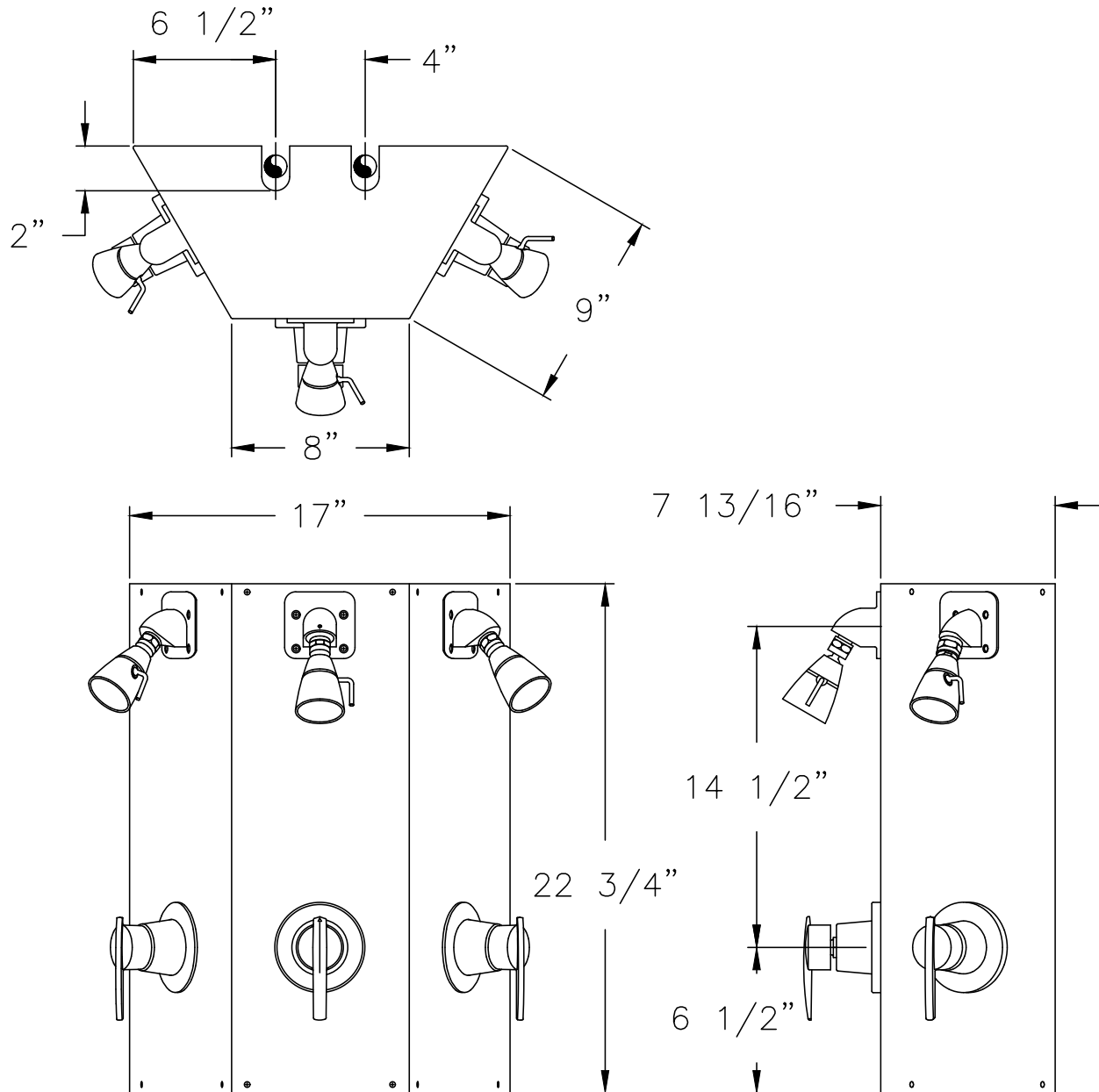

NOTE: All dimensions are for reference only. Do not use for pre-plumbing.