

**Z897-12**

SPECIFICATION SHEET

**14-1/2 [369] WIDE REVEAL x 24-1/8 [613] LONG  
CATCH BASIN**

TAG \_\_\_\_\_

Dimensional Data (inches and [ mm ]) are Subject to Manufacturing Tolerances and Change Without Notice

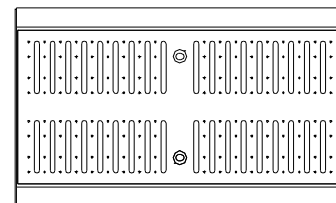
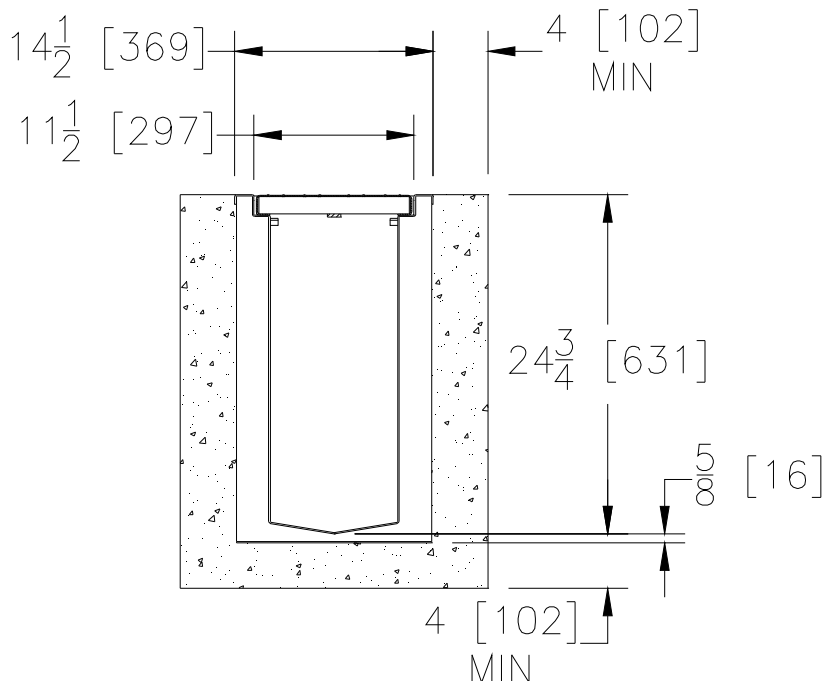
SPECIFYING ENGINEER IS RESPONSIBLE FOR  
CONCRETE ENCASEMENT AND REINFORCING  
BASED UPON APPLICATION AND LOCAL CODES**ENGINEERING SPECIFICATION: Zurn Z897-12**

Catch Basin shall be 14-1/2 [369] wide reveal x 24-1/8 [613] long and 24 [610] deep. The body shall be made of 12ga. fabricated stainless steel conforming to ASTM A-240 (type 304). Catch basin shall weigh less than 20 bs.[9.1kg] per linear foot. Shall be provided with the standard RFS grates. Zurn 12 [305] wide reveal Stainless Steel Reinforced Slotted Grate conforming to ASTM specification A351, Grade CF8 (type 304), Fabricated grate is rated class B per the DIN EN1433 top load classification. Supplied in 24 [608] nominal lengths with 3/8 [10] wide slots, 1-1/2 [38] bearing depth. Grate has an open area of 25.61 sq. in. per ft [54207 sq. mm per meter]. Basins shall be produced in the U.S.A.

**PREFIX OPTIONS (Check/specify appropriate options)**

\_\_\_ Z Twelve-inch by Twenty Four-inch, Type 304 Stainless Steel\*

**SUFFIX OPTIONS (Check/specify appropriate options)****Outlet Adapters Add/Each**

\_\_\_ -E3 3 [76] No-Hub End Outlet \_\_\_ -U3 3 [76] No-Hub Bottom Outlet  
\_\_\_ -E4 4 [102] No-Hub End Outlet \_\_\_ -U4 4 [102] No-Hub Bottom Outlet  
\_\_\_ -E6 6 [152] No-Hub End Outlet \_\_\_ -U6 6 [152] No-Hub Bottom Outlet

**Grate Options (Load Classifications are per DIN EN1433)**

\_\_\_ -BDC Black Acid Resistant Epoxy Coated Ductile Grate - Class C  
\_\_\_ -BDE Black Acid Resistant Epoxy Coated Ductile Grate - Class E  
\_\_\_ -DC Ductile Iron Solid Cover - Class C  
\_\_\_ -DGC Ductile Iron Slotted Grate - Class C  
\_\_\_ -DGE Ductile Iron Slotted Grate - Class E  
\_\_\_ -DGF Ductile Iron Slotted Grate - Class F  
\_\_\_ -HPD Heel-Proof Ductile Slotted Grate - Class C  
\_\_\_ -HPDE Heel-Proof Ductile Slotted Grate - Class E  
\_\_\_ -RFSC Reinforced Slotted Stainless Steel Grate - Class C  
\_\_\_ -RPSC Reinforced Perforated Stainless Steel Grate - Class C  
\_\_\_ -RPSRC Reinforced Perforated Stainless Steel Reversed Punch Grate - Class

**MADE in the U.S.A.**

\_\_\_ -ADA-USA Meets Americans with Disabilities Act Requirements - Class C  
\_\_\_ -DGC-USA Ductile Iron Slotted Grate - Class C  
\_\_\_ -DGE-USA Ductile Iron Slotted Grate - Class E  
\_\_\_ -FG Fabricated Galvanized Steel Slotted Grate - Class A  
\_\_\_ -FS Fabricated Stainless Steel Slotted Grate - Class A  
\_\_\_ -GG Fiberglass Grate - Class A  
\_\_\_ -HPDE-USA Heel-Proof Ductile Slotted Grate - Class E  
\_\_\_ -PS Perforated Stainless Steel Grate - Class A  
\_\_\_ -RFS Reinforced Stainless Steel Slotted Grate - Class B \*  
\_\_\_ -RPS Reinforced Stainless Steel Perforated Grate - Class B

**MADE in the U.S.A.**

\_\_\_ -SBG-L Stainless Steel Bar Grate - Class C

**Miscellaneous Options**

\_\_\_ -DB Bottom Dome Strainer

\*REGULARLY FURNISHED UNLESS OTHERWISE SPECIFIED

**REV. D DATE: 5/8/12 C.N. NO. 124235****PROD/DWG. NO. Z897-12**

ZURN INDUSTRIES, LLC ♦ SPECIFICATION DRAINAGE OPERATION ♦ 1801 Pittsburgh Ave. ♦ Erie, PA 16514

Phone: 814/455-0921 ♦ Fax: 814/454-7929 ♦ World Wide Web: www.zurn.com

In Canada: ZURN INDUSTRIES LIMITED ♦ 3544 Nashua Drive ♦ Mississauga, Ontario L4V1L2 ♦ Phone: 905/405-8272 Fax: 905/405-1292